

# STATIC

# ACTIVE

## 1. environs

- bridge
- building
- property line
- transit

## 2. street & traffic

- center line
- crosswalk
- curb
- cycle lane
- motor vehicle parking
- motor vehicle travel lane
- stop line

## 3. streetscape

- bus stop
- catch basin
- door
- driveway
- hydrant
- pedestrian ramp
- street lamp
- traffic signal
- tree pit

## 4. traffic flow

- bicycle, slow traffic
- bus
- motor vehicles
- pedestrian
- "staying"

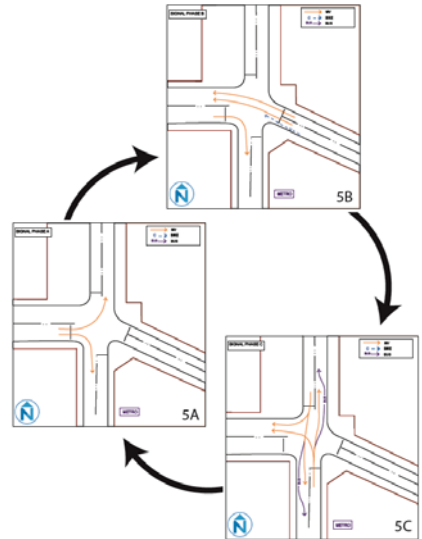

## 5. signal and phasing



## 6. volumes and speed

- MV volume
- MV speed
- bicycle volumes
- bicycle speeds
- pedestrian volumes









ENVIRONS

	PROPERTY LINE
	BUILDING
	BRIDGE

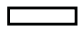

METRO

STREET & TRAFFIC

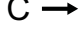
	PROPERTY LINE
	BUILDING
	BRIDGE
	CURB
	CENTER LINE
	STOP LINE
	CROSSWALK
	MV TRAVEL LANE
	PARKING
	CYCLE LANE

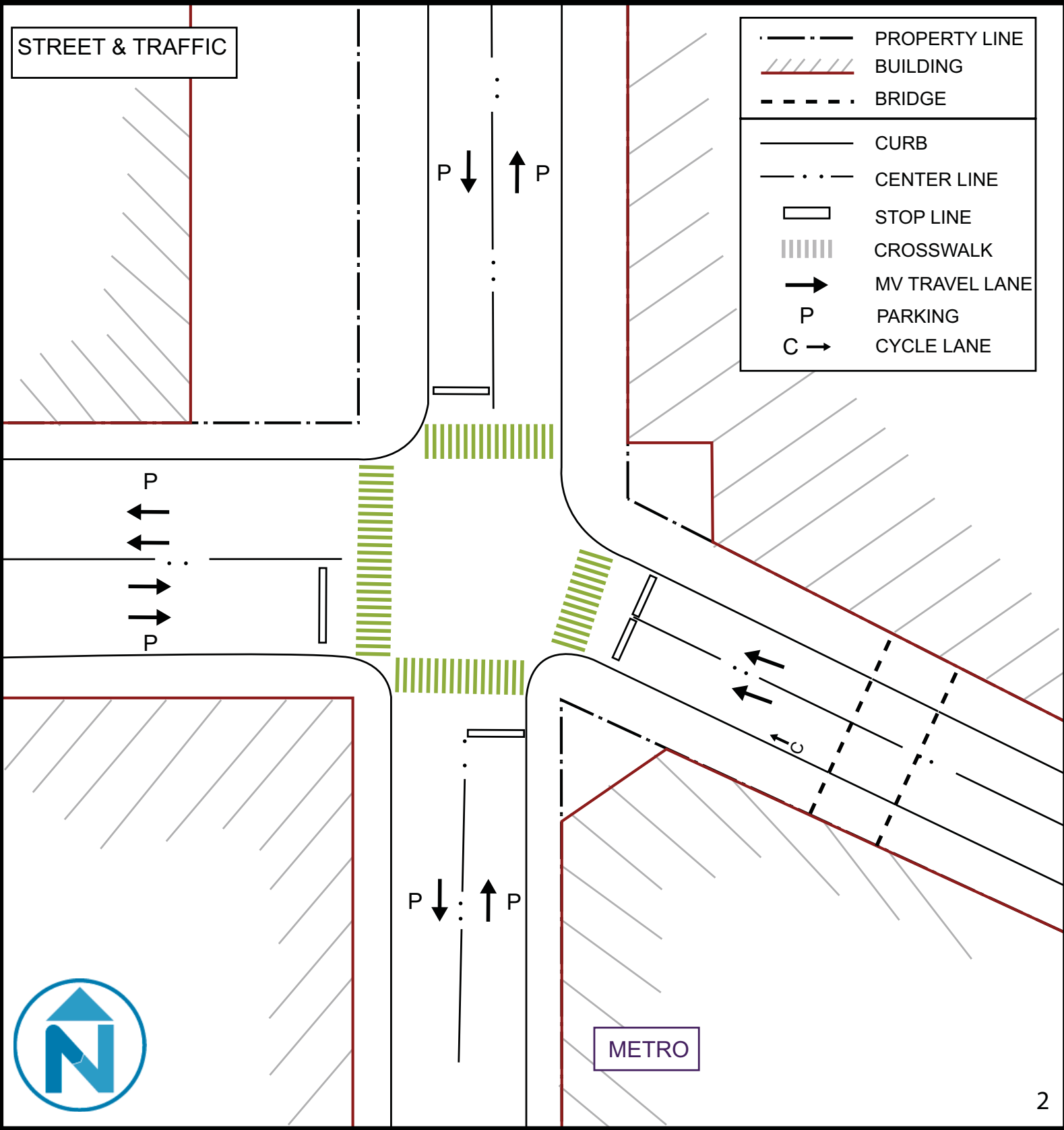

METRO

STREETSCAPE

	PROPERTY LINE
	BUILDING
	BRIDGE
	CURB
	CENTER LINE
	STOP LINE
	CROSSWALK
	MV TRAVEL LANE
	PARKING
	CYCLE LANE
	CATCH BASIN
	DOOR
	HYDRANT
	BUS STOP
	SIGNAL



METRO

	TREE PIT
	STREET LAMP
	PED RAMP
	DRIVEWAY

TRAFFIC FLOW

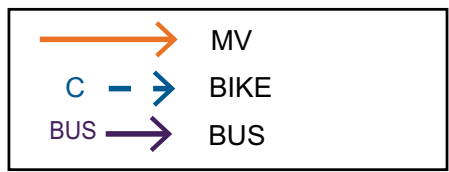

METRO

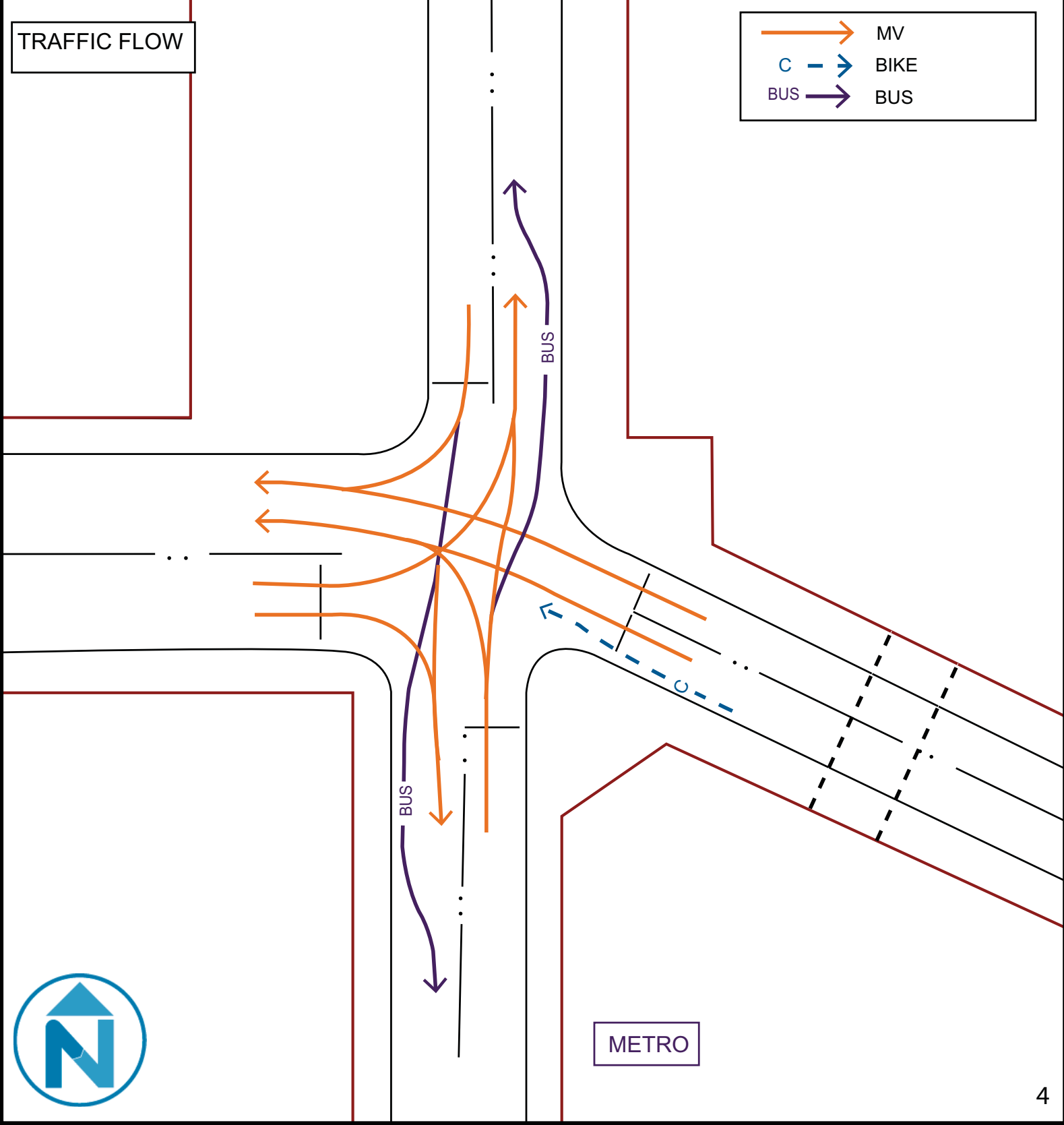

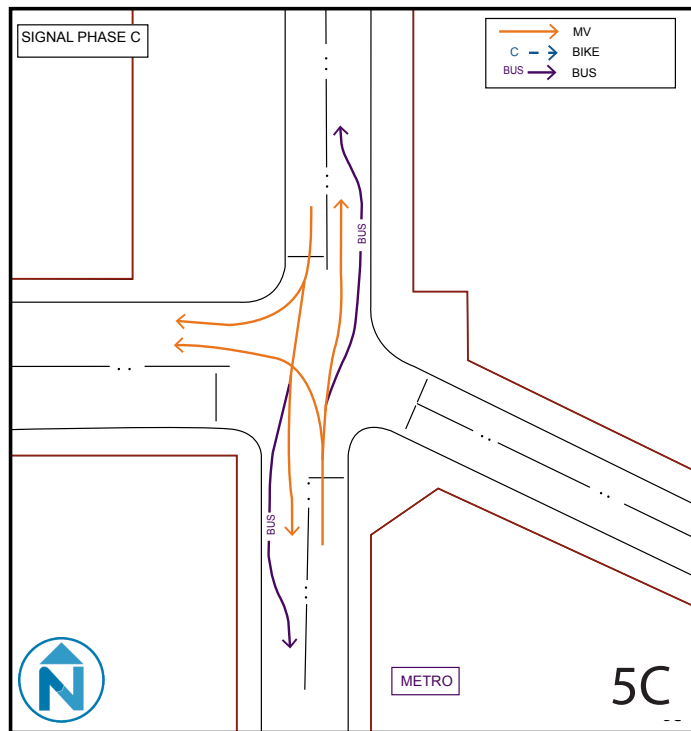
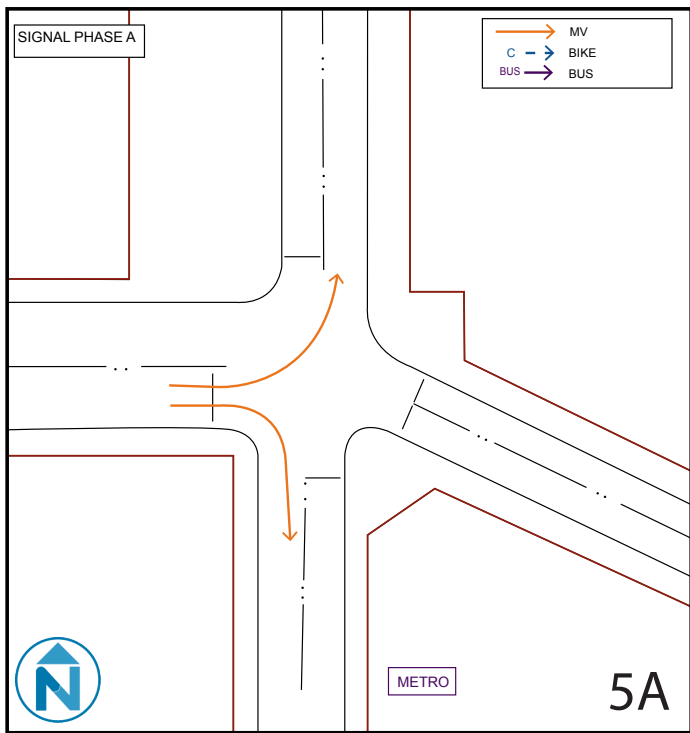
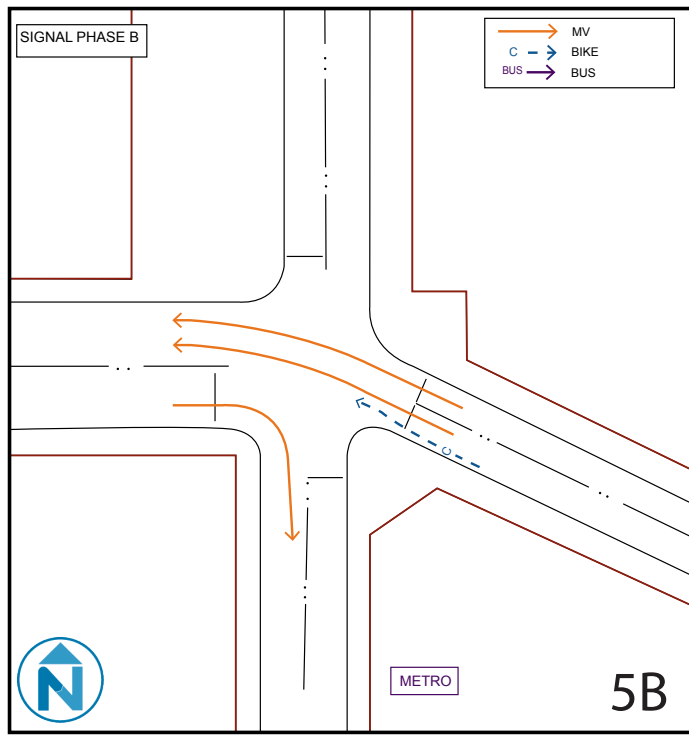

PEDESTRIAN FLOW

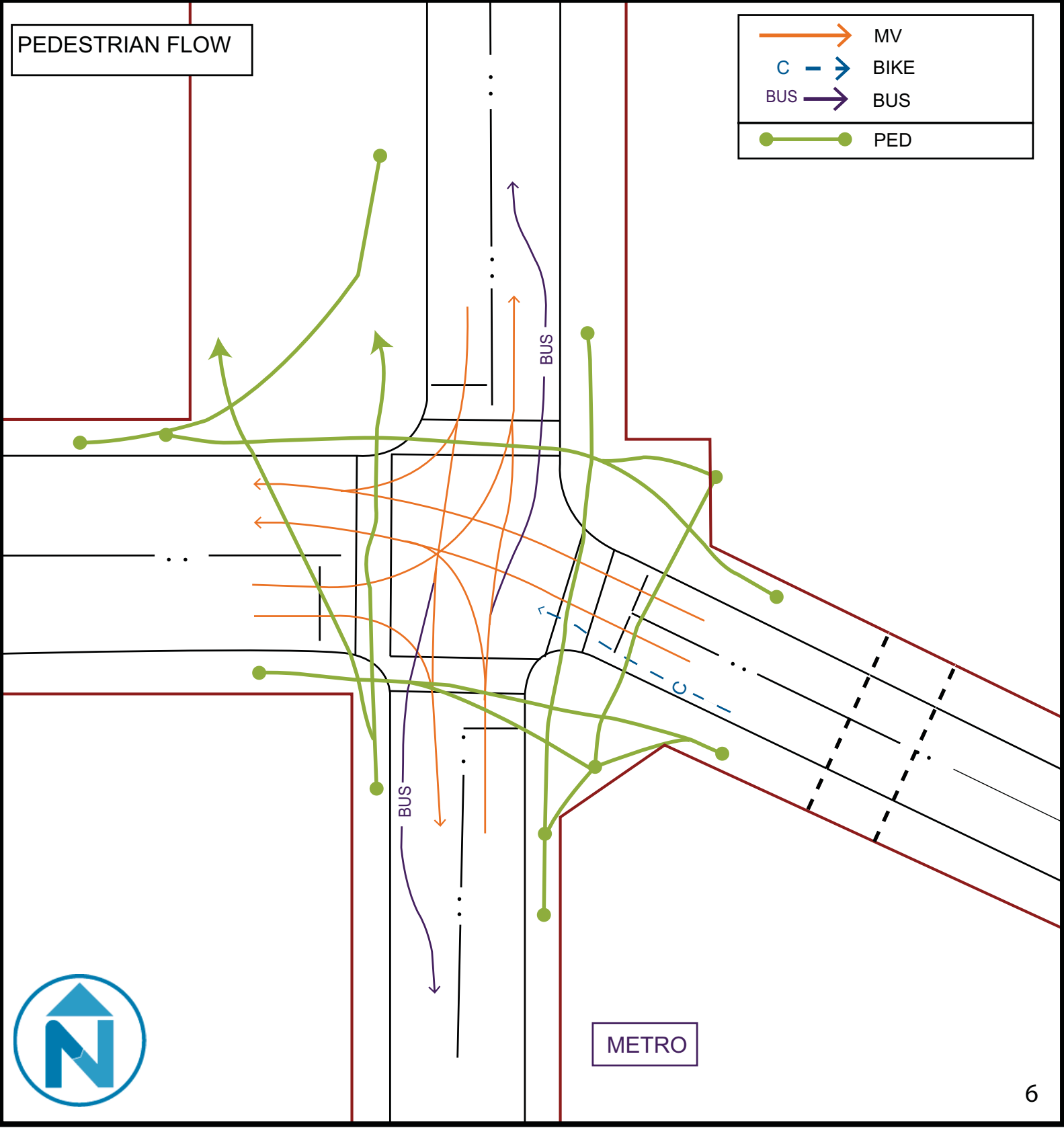
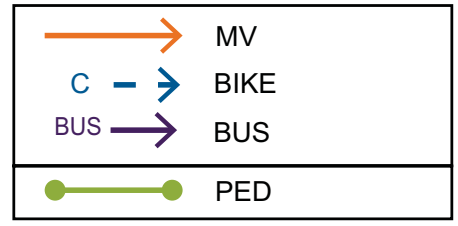

METRO

# VOLUME & TRACKING SURVEYS

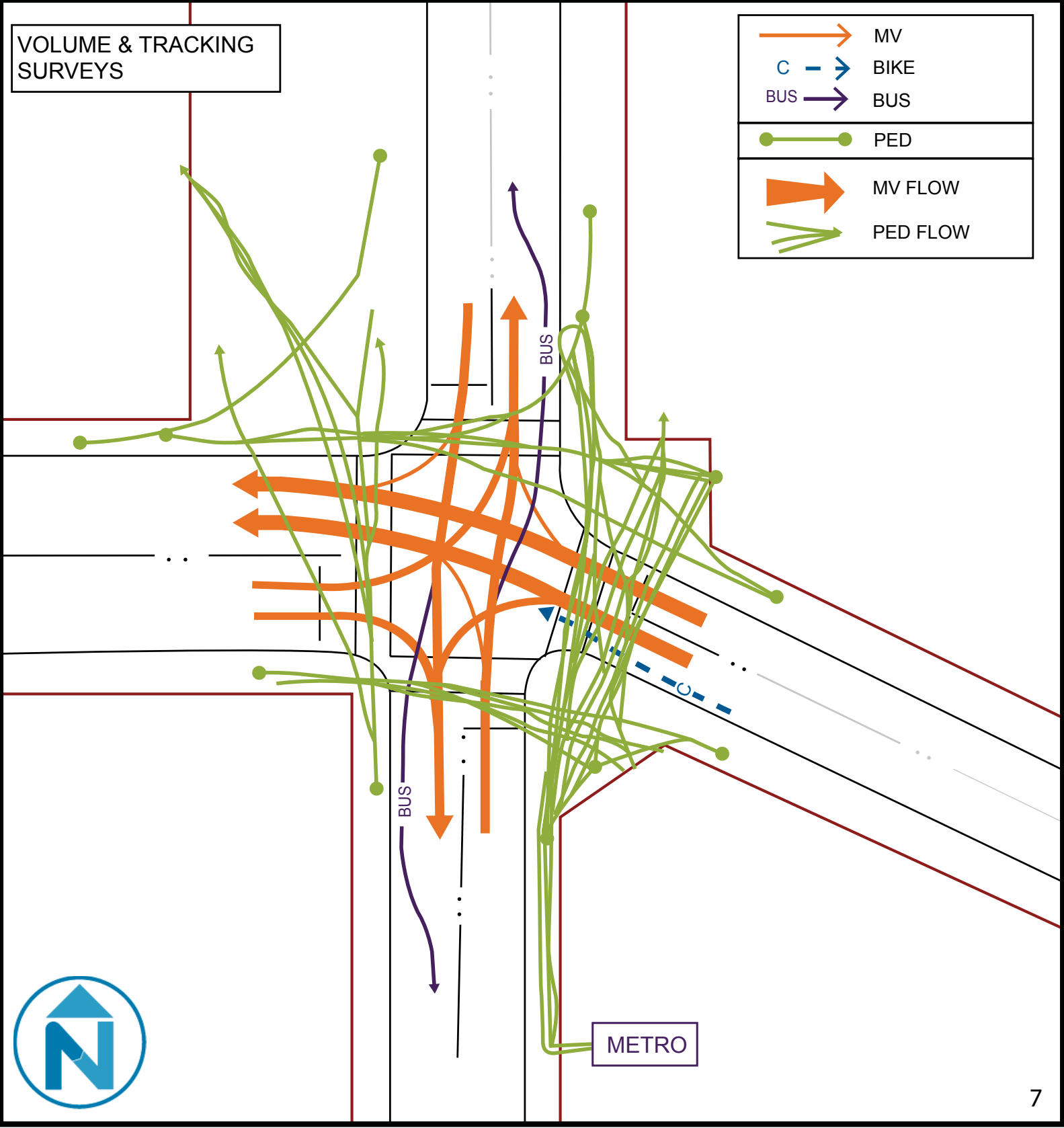
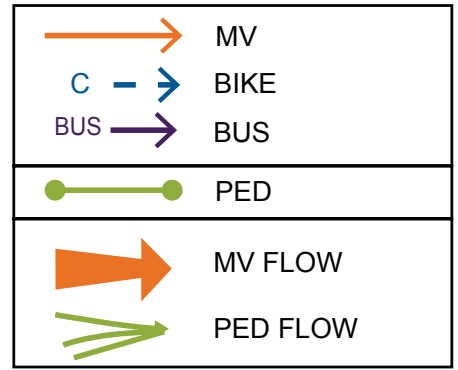

METRO



ISSUES & OPPORTUNITIES  
W/ TRAFFIC & PEDESTRIAN FLOWS

